

DINSEN

Professional Car Jack Manufacturer

[Http://www.dsjack.com](http://www.dsjack.com)

Electric Hydraulic Jack • Electric Impact Wrench • Auto Inflator Pump



Add:NO.3 Changjiang Road,Economic Development Area Phase 2, Wenling city 317500, Zhejiang,China

Tel:0086-576-86165858 0086-576-86135858

Fax:0086-576-81633882

Email: info@dsjack.com

[Http://www.dsjack.com](http://www.dsjack.com)



WENLING DINSEN M&E CO.,LTD



about us

Located in coastal city Wenling, Zhejiang, WENLING DINSEN M&E CO.,LTD was founded in 2012. We independently develop, produce and sell electric jacks, air pumps, electric wrenches and other high-tech car emergency products, which with more than 30 patented technologies; We have more than 15 persons of R&D teams, providing professional design and customized technical services for customers. Meanwhile, we have obtained the certifications of ISO9001, CE, EMC, RoHS, also passed US ASME PASE-2014 standard and Australia Standard AS/NZS 2693.

We take "Innovation Management" as our tenet, found our R&D department, at the same time importing advanced SAMSUNG CNC Machining Center, 3D Scanner and OBJECT EDEN260V Rapidform Machine as our production equipments; also owning advanced Three-coordinate Measuring Machine and independent R&D testing bed as the inspection equipments.

By right of our continuous hard-working and pursuing high-quality products all along, our products are exported to all over the world and get high appraisal from our customers at home and abroad.

We persist in "Honesty Management and Perfect Service", taking the market as guider, the talent as foundation and the innovation as means to obtain leap-forward development. Meanwhile all of us expect to cooperate with more customers in wider fields, leading to brighter future between us.



DSTZ01

FEATURES:

- ◆ 1.The whole set of Car Repair Tool Kit for Electric Car Jack and Electric Impact Wrench
- ◆ 2.3in1:Lifting+Inflating+Changing the wheel
- ◆ 3.With BMC packing,easy to carry
- ◆ 4.Portable,economical,practical tool kit
- ◆ 5.Matching with the relevant complete small tools,like safety hammer,gloves
- ◆ 6.Convenient to operate,and solve the problem in one step
- ◆ 7.With CE,US ASME PASE-2014,ROHS,ISO9001 certificates,quality is guaranteed



Packing list

NO.	Name	Quantity
1	2 in 1 Electric Jack	1pc
2	Electric Impact Wrench	1pc
3	Safety Hammer	1pc
4	Plastic Tool box	1pc
5	Battery Clamp Connecting Cable	1pc
6	Gloves	1pair
7	Power Cable	1pc
8	Socket Adapters	2pcs
9	Fuse	2pcs
10	Instruction Manual	1pc

Product Name	3 in 1 Car Repair Tool Kit for Electric Car Jack and Electric Impact Wrench(DSJA370+DSEW01)
Model NO.	DSTZ01
DSJA370(2 in 1:Lifting+Inflating)	
Lifting Function Specification	
Rated Power	150W
Operating Voltage	DC 12V
Max.Current	13A
Max.Loading Car Weight	3T
Min.Height	135/155mm
Max.Height	360/450mm
Inflating Function Specification	
Max Pressure	150PSI
Air Flow	35L/min
Current	10A
Air hose length	0.65m
Power Cable	3.5m
DSEW01	
Operating Voltage	DC 12V
Max.Current	12A
Rated Power	100W
Max.Torque	340N.M
Power Cable	3.5m
DSTZ01 PACKING	
Package	BMC with polybag
N.W./G.W	9.0/9.3kgs
Master Carton Size	570*395*375mm
Set/ctn	3pcs
20FT	996pcs



Take power



Lifting



Wrench



Air Pump

DSTZ02 DSTZ02-1

FEATURES:

- ◆ 1. Super low pressure rod, suitable for the sports car
- ◆ 2. With LED light in the front, easy for night illumination
- ◆ 3. Flashing warning light in the back, guarantee personal safety



DSTZ02



DSTZ02-1



Packing list

NO.	Name	Quantity
1	2 in 1 Electric Jack	1pc
2	Electric Impact Wrench	1pc
3	Safety Hammer	1pc
4	Plastic Tool box	1pc
5	Battery Clamp Connecting Cable	1pc
6	Gloves	1pair
7	Power Cable	1pc
8	Socket Adapters	2pcs
9	Fuse	2pcs
10	Instruction Manual	1pc

Product Name	4 in 1 Car Repair Tool Kit for Electric Car Jack and Electric Impact Wrench(DSJA380/DSJA380-1+DSEW01)	
Model NO.	DSTZ02	
	DSJA380/DSJA380-1(3 in 1:Lifting+Inflating+LED Light)	
	Lifting Function Specification	
	DSJA380	DSJA380-1
Rated Power	150W	150W
Operating Voltage	DC 12V	DC 12V
Max.Current	13A	13A
Max.Loading Car Weight	3T	3T
Min.Height	115/135/155mm	135/155mm
Max.Height	310/360/450mm	360/450mm
	Inflating Function Specification	
Max Pressure	150PSI	150PSI
Air Flow	35L/min	35L/min
Current	10A	10A
Air hose length	0.65m	0.65m
Power Cable	3.5m	3.5m
	DSEW01	
Operating Voltage	DC 12V	DC 12V
Max.Current	12A	12A
Rated Power	100W	100W
Max.Torque	340N.M	340N.M
Power Cable	3.5m	3.5m
	DSTZ02 PACKING	
Package	BMC with polybag	BMC with polybag
N.W./G.W	8.2/8.5kgs	8.5/8.8kgs
Master Carton Size	570*350*370mm	570*350*370mm
Set/ctn	3pcs	3pcs
20FT	1152pcs	1152pcs



LED Light



Warning Light

DSTZ03

FEATURES:

- ◆ 1. Economical, practical electric scissor jack
- ◆ 2. With BMC packing, easy to carry
- ◆ 3. Matching with battery clamp connecting cable
- ◆ 4. 3.5M power cable with the adapter of auto cigarette lighter
- ◆ 5. The machine just connects the car cigarette lighter, then the car will be risen and fallen



Packing list

NO.	Name	Quantity
1	Electric Jack	1pc
2	Electric Impact Wrench	1pc
3	Screwdriver	1pc
4	Manual handle	1pc
5	Plastic Tool box	1pc
6	Battery Clamp Connecting Cable	1pc
7	Gloves	1pair
8	Power Cable	1pc
9	Socket Adapters	2pcs
10	Fuse	3pcs
11	Instruction Manual	2pcs

Product Name	2 in 1 Car Repair Tool Kit
Model NO.	DSTZ03
	DSJ0380
Rated Power	150W
Operating Voltage	DC 12V
Max.Current	13A
Fuse	15A
Max.Loading Car Weight	3T
Lift Range	120-350mm
Power Cable	3.5m
	DSEW01
Operating Voltage	DC 12V
Max.Current	12A
Rated Power	100W
Max.Torque	340N.M
Power Cable	3.5m
DSTZ03 PACKING	
Package	BMC with polybag
N.W./G.W	7.6/7.9kgs
Master Carton Size	465*400*365mm
Set/ctn	3pcs
20FT	1230pcs

DSTZ04

FEATURES:

- ◆ 1.The whole set of Car Repair Tool Kit for Electric Car Jack and Electric Impact Wrench.
- ◆ 2.2 in 1:Lifting + Changing the wheel
- ◆ 3.With BMC packing ,easy to carry
- ◆ 4.Portable,economical,practical tool kit.
- ◆ 5.Matching with the relevant complete small tools,like safely hammer,gloves.
- ◆ 6.Convenient to operate,and solve the problem in one step
- ◆ 7.Design of super bright LED light,easy for night illumination.



Packing list

NO.	Name	Quantity
1	Electric Jack	1pc
2	Electric Impact Wrench	1pc
3	Safety Hammer	1pc
4	Plastic Tool box	1pc
5	Battery Clamp Connecting Cable	1pc
6	Gloves	1pair
7	Power Cable	1pc
8	Socket Adapters	2pcs
9	Fuse	2pcs
10	Instruction Manual	1pc



Product Name	2 in 1 Car Repair Tool Kit
Model NO.	DSTZ04
DSJ0370 Lifting Function Specification	
Rated Power	150W
Operating Voltage	DC 12V
Max.Current	13A
Max.Loading Car Weight	3T
Min.Height	135/155mm
Max.Height	360/450mm
DSEW01	
Operating Voltage	DC 12V
Max.Current	12A
Rated Power	100W
Max.Torque	340N.M
Power Cable	3.5m
DSTZ04 PACKING	
Package	BMC with polybag
N.W./G.W	8.2/8.5kgs
Master Carton Size	570*395*375mm
Set/ctn	3pcs
20FT	996pcs

DSTZ05/DSTZ05-LB

FEATURES:

- ◆ 1.Unique and fashionable design,making it highly individual
- ◆ 2.Digital Meter to control the Tyre Pressure,much easier to operate
- ◆ 3.DC 12V lighter powered
- ◆ 4.Max.Loading Car Weight:5.0Ton.
- ◆ 5.With Double Cylinder for the pump,making the inflating speed faster
- ◆ 6.With LED light,easy for night illumination



Packing list

NO.	Name	Quantity
1	2 in 1 Electric Jack	1pc
2	Electric Impact Wrench	1pc
3	Safety Hammer	1pc
4	Plastic Tool box	1pc
5	Battery Clamp Connecting Cable	1pc
6	Gloves	1pair
7	Power Cable	1pc
8	Socket Adapters	2pcs
9	Fuse	2pcs
10	Instruction Manual	1pc
11	Lithium Battery	Optional

Specification

Battery Capacity :	12000mAh(44.4Wh)
Input :	Quick Charge(5V/2.4A,9V/2A)
Output :	12V/10A(12V car electronic products) 12V Jump Starter
Start Current :	200A
Peak Current :	400A
Operating Temp :	-20°C ~ 60°C
Lifetime :	> 1000cycles

Safety Design Eight Protections

-  **Short-Circuit Protection**
Prevent short-circuit occurring while two clamps are connected
-  **Over-charge protection**
Effectively prevent over-charge of the battery in the jump starter
-  **Over-discharge protection**
Effectively prevent over-discharge of the battery in the jump starter
-  **Over-current protection**
Protect when discharge current too high
-  **Over-temperature Protection**
Automatically stop working when the temperature is getting too high
-  **Reverse Polarity Protection**
No damage happened while the clamps are connected in wrong terminals
-  **Reverse-charge Protection**
No reverse charging back to Carku unit after the vehicle started
-  **Over-voltage protection**
Prevent there is big voltage difference between each cell

Product Name	5in1 Car Repair Tool Kit (DSJA380-2+DSEW01)
Model NO.	DSTZ05
DSJA380-2(3 in 1:Lifting+Inflating+LED Light)	
Lifting Function Specification	
Rated Power	150W
Operating Voltage	DC 12V
Max.Current	13A
Max.Loading Car Weight	5T
Min.Height	135/155mm
Max.Height	360/450mm
Inflating Function Specification	
Max Pressure	150PSI
Air Flow	65L/min
Current	13A
Air hose length	0.65m
Power Cable	3.5m
DSEW01	
Operating Voltage	DC 12V
Max.Current	12A
Rated Power	100W
Max.Torque	340N.M
Power Cable	3.5m
DSTZ05 PACKING	
Package	BMC with polybag
N.W./G.W	9.3/9.6kgs (With Lithium Battery 10/10.3kgs)
Master Carton Size	570*395*375mm
Set/ctn	3pcs
20FT	996pcs

DSJA370

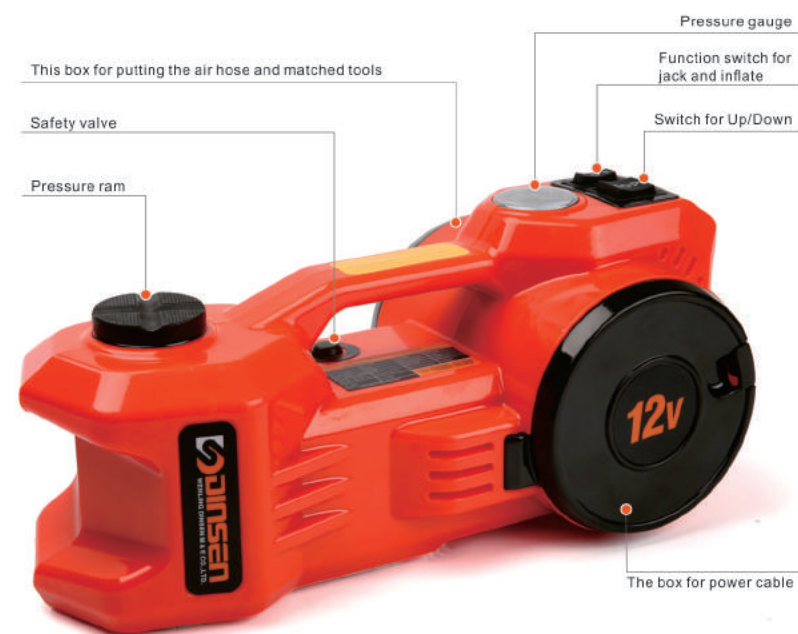

FEATURES:

- ◆ 1. Combine two functions of jack and Tyre Inflator Pump in one machine
- ◆ 2. Adopt self-developed small flow and large efficiency gear pump, reduce electrical power, reduce the work of car batteries and circuits, to ensure the car circuit is not affected
- ◆ 3. Design of current overload protection
- ◆ 4. Design self-locking power structure and safety unloading knob, in case of the power has been disconnected, the increased jack will not fall. Then when re-connecting the power, jack will go on working in accordance with the instruction, or using the safety unloading knob to fall, which will protect the user's personal safety effectively
- ◆ 5. Fully enclosed design of the hydraulic tank, the machine used at any angles will not leak oil.
- ◆ 6. The machine just connects the auto cigarette lighter, then the auto will be risen and fallen.
- ◆ 7. Portable, compact and easy to operate.
- ◆ 8. Air hose, power cable and tools collected in the tool box neatly when not in use.

Product Name	Multi-functional jack(2 in 1:Lifting+Inflating)	
Type	Common	Update
Model No.	DSJA370	DSJA370+
	Lifting Function Specification	
Rated Power	150W	150W
Operating Volage	DC 12V	DC 12V
Max.Current	13A	13A
Fuse	15A	15A
Max.Loading Car Weight	3T	3T
Lift Range	135-360mm	155-450mm
	Inflating Function Specification	
Max Pressure	150PSI	150PSI
Air Flow	35L/min	35L/min
Current	10A	10A
Air hose length	0.65m	0.65m
Power Cable	3.5m	3.5m
Package	Color box with foam	
N.W./G.W.	4.4/4.9kgs	4.7/5.2kgs
Master Carton Size	390*370*395mm	390*370*395mm
Set/ctn	4pcs	4pcs
20FT	1960pcs	1960pcs



DSJA380 DSJA380-1

FEATURES:

- ◆ 1. Combine two functions of jack and Tyre Inflator Pump in one machine
- ◆ 2. Adopt self-developed small flow and large efficiency gear pump, reduce electrical power, reduce the work of car batteries and circuits, to ensure the car circuit is not affected
- ◆ 3. Design of current overload protection
- ◆ 4. Design self-locking power structure and safety unloading knob, in case of the power has been disconnected, the increased jack will not fall. Then when re-connecting the power, jack will go on working in accordance with the instruction, or using the safety unloading knob to fall, which will protect the user's personal safety effectively
- ◆ 5. Fully enclosed design of the hydraulic tank, the machine used at any angles will not leak oil.
- ◆ 6. The machine just connects the auto cigarette lighter, then the auto will be risen and fallen.
- ◆ 7. Portable, compact and easy to operate.
- ◆ 8. Air hose, power cable and tools collected in the tool box neatly when not in use.



Product Name	Multi-functional jack(3 in 1:Lifting+Inflating+ Light)	
Model No.	DSJA380	DSJA380-1
Lifting Function Specification		
Rated Power	150W	150W
Operating Volage	DC 12V	DC 12V
Max.Current	13A	13A
Fuse	15A	15A
Max.Loading Car Weight	3T	3T
Min.Height	115/135/155mm	135/155mm
Max.Height	310/360/450mm	360/450mm
Inflating Function Specification		
Max Pressure	150PSI	150PSI
Air Flow	35L/min	35L/min
Current	10A	10A
Air hose length	0.65m	0.65m
Power Cable	3.5m	3.5m
Package	Color box with foam	Color box with foam
N.W./G.W.	4.4/4.9kgs	4.7/5.2kgs
Master Carton Size	380*345*405mm	380*345*405mm
Set/ctn	4pcs	4pcs
20FT	2108pcs	2108pcs



DSJA380-2

FEATURES:

- ◆ 1.Unique and fashionable design,making it highly individual
- ◆ 2.Digital Meter to control the Tyre Pressure,much easier to operate
- ◆ 3.DC 12V lighter powered
- ◆ 4.Max.Loading Car Weight:5.0Ton.
- ◆ 5.With Double Cylinder for the pump,making the inflating speed faster
- ◆ 6.With LED light,easy for night illumination



Product Name	Multi-functional jack(3 in 1:Lifting +Inflating + Light)	
Type	Common	Update
Model No.	DSJA380-2	DSJA380-2+
Lifting Function Specification		
Rated Power	150W	150W
Operating Volage	DC 12V	DC 12V
Max.Current	13A	13A
Fuse	15A	15A
Max.Loading Car Weight	5T	5T
Lift Range	135-360mm	155-450mm
Inflating Function Specification		
Max Pressure	150PSI	150PSI
Air Flow	65L/min	65L/min
Current	13A	13A
Air hose length	0.65m	0.65m
Power Cable	3.5m	3.5m
Package	Color box with foam	Color box with foam
N.W./G.W.	5.0/5.5kgs	5.3/5.8kgs
Master Carton Size	390*370*395mm	390*370*395mm
Set/ctn	4pcs	4pcs
20FT	1960pcs	1960pcs

DSJA380-3

Specification

Battery Capacity :	12000mAh(44.4Wh)
Size :	389×226×154.5mm
Weight :	5600g
Input :	Quick Charge(5V/2.4A;9V/2A)
Output :	12V/10A(12V car electronic products) 12V Jump Starter
Start Current :	200A
Peak Current :	400A
Operating Temp :	-20°C ~ 60°C
Lifetime :	> 1000cycles



Jump start Built-in air inflator Electric jack car electronic products charge SOS/lighting

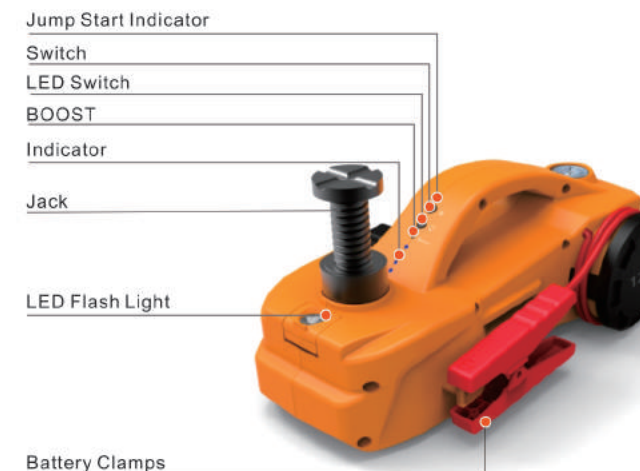

Jack Specification	
Rated power :	150W
Operating voltage :	DC 12V
Max current :	13A
Max loading (car weight) :	3T
Height Range :	135-365mm/155-450mm



Air inflator Specification	
Operating voltage :	DC 12V
Max pressure :	150PSI
Max current :	10A
Flow :	35L/min
Length of air hose :	About 0.65m

Safety Design Eight Protections

-  **Short-Circuit Protection**
Prevent short-circuit occurring while two clamps are connected
-  **Over-temperature Protection**
Automatically stop working when the temperature is getting too high
-  **Over-charge protection**
Effectively prevent over-charge of the battery in the jump starter
-  **Reverse Polarity Protection**
No damage happened while the clamps are connected in wrong terminals
-  **Over-discharge protection**
Effectively prevent over-discharge of the battery in the jump starter
-  **Reverse-charge Protection**
No reverse charging back to Carku unit after the vehicle started
-  **Over-current protection**
Protect when discharge current too high
-  **Over-voltage protection**
Prevent there is big voltage difference between each cell

Key feature



DSJ0370

FEATURES:

- ◆ 1. Adopt self-developed small flow and large efficiency gear pump,reduce electrical power,reduce the work of car batteries and circuits,to ensure the car circuit is not affected
- ◆ 2. Design of current overload protection
- ◆ 3. Design self-locking power structure and safety unloading knob,in case of the power has been disconnected,the increased jack will not fall,then when re-connecting the power,jack will go on working in accordance with the instruction,or using the safety unloading knob to fall,which will protect the user's personal safety effectively.
- ◆ 4. Fully enclosed design of the hydraulic tank,the machine used at any angles will not leak oil.
- ◆ 5. The machine just connects the car cigarette lighter,then the car will be risen and fallen.
- ◆ 6. Portable,compact and easy to operate.
- ◆ 7. Design of super bright LED light,easy for night illumination



Product Name	Single functionl Jack	
Type	Common	Update
Model No.	DSJ0370	DSJ0370+
Rated Power	150W	150W
Operating Volage	DC 12V	DC 12V
Max.Current	13A	13A
Fuse	15A	15A
Max.Loading Car Weight	3T	3T
Lift Range	135-360mm	155-450mm
Power Cable	3.5m	3.5m
Package	Color box with foam	
N.W./G.W.	3.6/4.0kgs	3.9/4.3kgs
Master Carton Size	340*320*380mm	340*320*380mm
Set/ctn	4pcs	4pcs
20FT	2708pcs	2708pcs



DSJ0380

FEATURES:

- ◆ 1. Economical, practical electric scissor jack
- ◆ 2. With BMC packing, easy to carry
- ◆ 3. Matching with battery clamp connecting cable
- ◆ 4. 3.5M power cable with the adapter of auto cigarette lighter
- ◆ 5. The machine just connects the car cigarette lighter, then the car will be risen and fallen

Product Name	Electric Jack
Model NO.	DSJ0380
Rated Power	150W
Operating Voltage	DC 12V
Max.Current	13A
Fuse	15A
Max.Loading Car Weight	3T
Lift Range	120-350mm
Power Cable	3.5m
Package	BMC with polybag
N.W./G.W	5.5/5.7kgs
Master Carton Size	525*450*260mm
Set/ctn	4pcs
20FT	1820pcs



DSJ0380-1

FEATURES:

- ◆ 1. The cover is metal, more durable and long lasting.
- ◆ 2. Design with current overload protection
- ◆ 3. New design, matched with 5m power cable
- ◆ 4. Design of bright LED light, easy for night illumination
- ◆ 5. Equipped with automatic telescopic sliding wheel, not only be easy to carry, but also adjust the position properly when lifting
- ◆ 6. Just connecting the vehicle cigar lighter, then the vehicle will be risen and fallen easily.
- ◆ 7. Matched with the Safety Valve, in any emergency, if the vehicle couldn't be fallen down by the jack, then we could use it to fall down by manually.
- ◆ 8. Widely used for saloon car, large pick-up truck, and the lorry for total weight within 10ton/15ton

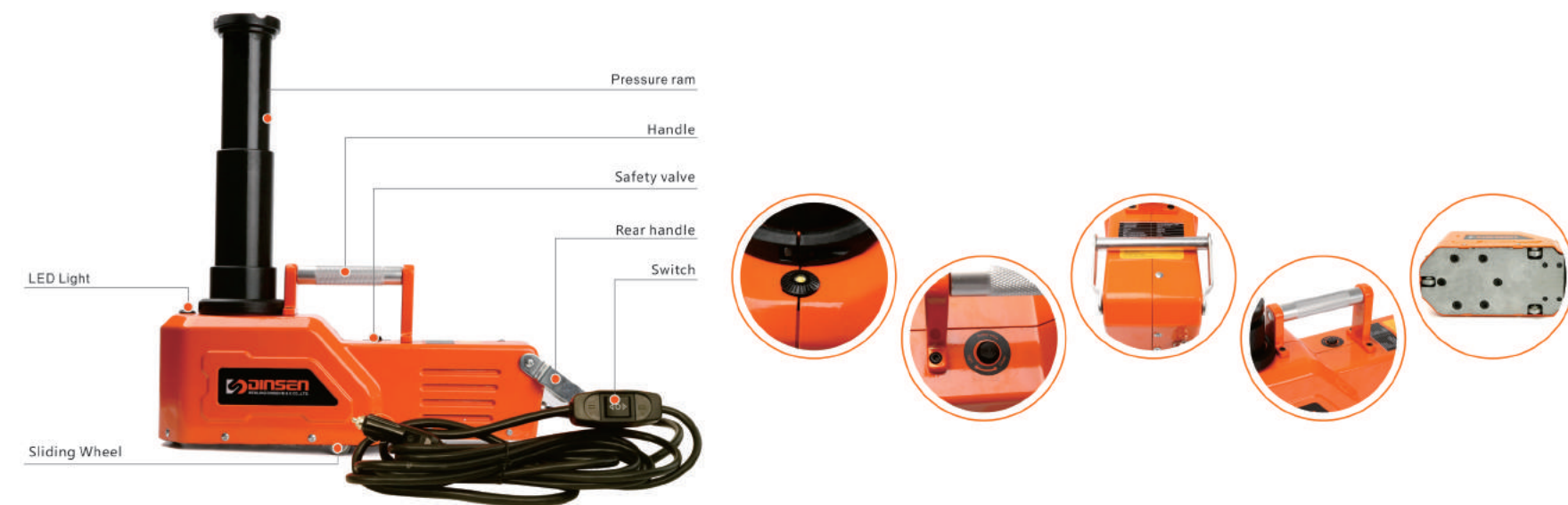

Product Name	Electric Jack
Model No.	DSJ0380-1
Rated Power	300W
Operating Volage	DC12V/24V
Max.Current	25A /15A
Fuse	30A /15A
Max.Loading Car Weight	10.0T/15.0T
Lift Range	200mm-520mm
Power Cable	5m
Package	Color box with foam/Woven bag with foam
N.W./G.W.	11.8kgs/12.5kgs
Master Carton Size	485mm×370mm×270mm
Set/cn	2pcs
20FT	1210pcs



Two kinds of packing

DSJ0380-2

FEATURES:

- ◆ 1.New design,matched with Lithium Battery.
- ◆ 2.The cover is metal,more durable and long lasting.
- ◆ 3.Design with current overload protection.
- ◆ 4.Design of LED light,easy for night illumination.
- ◆ 5.Equipped with automatic telescopic sliding wheel,not only be easy to carry,but also adjust the position properly when lifting.
- ◆ 6.Matched with the Safety Valve,in any emergency,if the vehicle couldn't be fallen down by the jack,then we could use it to fall down by manually.
- ◆ 7.Widely used for saloon car ,large pick-up truck,and the lorry for total weight within 10ton/15ton.
- ◆ 8.The Lithium Battery could be used as for Jump Starter.Jump under 4.0L gasoline cars.
- ◆ 9.The Lithium Battery with the functions of Reverse-charge Protection,Short-Circuit Protection,Over-temperature Protection,Reverse Polarity Protection,Over-discharge Protection,Over-charge Protection.



Safety Design Eight Protections



Short-Circuit Protection

Prevent short-circuit occurring while two clamps are connected



Over-temperature Protection

Automatically stop working when the temperature is getting too high



Over-charge protection

Effectively prevent over-charge of the battery in the jump starter



Reverse Polarity Protection

No damage happened while the clamps are connected in wrong terminals



Over-discharge protection

Effectively prevent over-discharge of the battery in the jump starter



Reverse-charge Protection

No reverse charging back to Carku unit after the vehicle started



Over-current protection

Protect when discharge current too high



Over-voltage protection

Prevent there is big voltage difference between each cell

Product Name	Electric Jack with lithium battery
Model No.	DSJ0380-2
Rated Power	300W
Operating Volage	DC12V/24V
Max.Current	25A /15A
Fuse	30A /15A
Max.Loading Car Weight	10.0T/15.0T
Lift Range	200mm-520mm
Power Cable	5m
Package	Color box with foam/Woven bag with foam
N.W./G.W.	12.3kgs/13.0kgs
Master Carton Size	485mm×370mm×270mm
Set/cn	2pcs
20FT	1210pcs

Specification

Battery Capacity :	12000mAh(44.4Wh)
Input :	Quick Charge(5V/2.4A;9V/2A)
Output :	12V/10A(12V car electronic products) 12VJump Starter
Start Current :	200A
Peak Current :	400A
Operating Temp :	-20°C ~ 60°C
Lifetime :	> 1000cycles



Two kinds of packing

DSEW01

FEATURES:

- ◆ 1. Well-chosen raw materials
- ◆ 2. Inside motor is durable and long lasting
- ◆ 3. Easy to operate, and suitable for outdoor working
- ◆ 4. Smart but powerful, quality is guaranteed
- ◆ 5. Extremely durable and reliable power tool
- ◆ 6. With LED light, easy for night illumination



Product Name	Electric Impact Wrench	
Model No.	DSEW01	
Rated Power	100W	
Operating Volage	DC 12V	
Max.Current	12A	
Fuse	15A	
Max.Torque	350N.M	
Socket Size	17-19/21-23mm	
Power Cable	3.5m	
Package	Color box with foam	Plastic tool box
N.W./G.W.	2.0/2.2kgs	2.8/3.0kgs
Master Carton Size	405*315*400mm	560*340*240mm
Set/ctn	6pcs	5pcs
20FT	3480pcs	3200pcs



Two kinds of packing

DSEW02

FEATURES:

- ◆ 1. Well-chosen raw materials
- ◆ 2. Inside motor is durable and long lasting
- ◆ 3. Easy to operate, and suitable for outdoor working
- ◆ 4. Smart but powerful, quality is guaranteed
- ◆ 5. Extremely durable and reliable power tool



Product Name	Electric Impact Wrench
Model No.	DSEW02
Rated Power	100W
Operating Volage	DC 12V
Max.Current	12A
Fuse	15A
Max.Torque	350N.M
Socket Size	17-19/21-23mm
Power Cable	3m
Package	BMC with polybag
N.W./G.W.	2.5/2.7kgs
Master Carton Size	425*275*430mm
Set/ctn	8pcs
20FT	4456pcs

DSIP01

FEATURES:

- 1.25mm cylinder diameter,with metal CORE for the pump
- ◆ 2.Portable,compact and easy to operate
- ◆ 3.Low noise,quick inflating,stable performance
- ◆ 4.Ovenproof 0.6M air hose with brass valve connector
- ◆ 5.3.0M power cable with the adapter of auto cigarette lighter
- ◆ 6.Available for inflating auto,motorcycle,bicycle,balloon,rubber dinghy and so on
- ◆ 7.Air hose,power cable and tools fit neatly underneath the pump when not in use.



Product Name	Inflator Pump
Model No.	DSIP01
Rated Power	120W
Operating Volage	DC 12V
Max.Current	10A
Fuse	10A
Max.Pressure	150PSI
Air Flow	35L/min
Air hose length	0.6m
Cylinder diameter	25mm
Power Cable	3.0m
Package	Color box with foam
N.W./G.W.	1.0/1.2kgs
Master Carton Size	665*260*270mm
Set/ctn	8pcs
20FT	4800pcs



DSIP02

FEATURES:

- ◆ 1. Double cylinder design with 30mm diameter
- ◆ 2. Portable,compact,powerful and easy to operate
- ◆ 3. Low noise,quick inflating,stable performance
- ◆ 4. Ovenproof 0.5M air hose with brass valve connector
- ◆ 5. 3.0M power cable with the adapter of auto cigarette lighter
- ◆ 6. Matching with 5.0m spring hose
- ◆ 7. Design with super bright LED light
- ◆ 8. Available for inflating auto,motorcycle,bicycle,balloon,rubber dinghy and so on,especially for 4x4 auto,bus



Product Name	Double Cylinder Pump
Model No.	DSIP02
Rated Power	300W
Operating Volage	DC 12V
Max.Current	15A
Max.Pressure	150PSI
Air Flow	70L/min
Air hose length	50cm
Cylinder diameter	2*30mm
Power Cable	3.0m
Package	BMC with polybag
N.W./G.W.	16.0/17.0kgs
Master Carton Size	520*365*310mm
Set/ctn	4pcs
20FT	1900pcs

DSL B01

FEATURES:

- ◆ 1.USB Charging:Charging Cell Phone or Tablet.
- ◆ 2.Jump start 12V vehicle.
- ◆ 3.For power supply to 12V vehicle or 12V electronics.
- ◆ 4.Approx.4-5hours recharging time,convenient to reuse it.
- ◆ 5.With the functions of Reverse-charge Protection,Short-Circuit Protection,Over-temperature Protection,Reverse Polarity Protection,Over-discharge Protection,Over-charge Protection.



Safety Design Eight Protections

- Short-Circuit Protection**
Prevent short-circuit occurring while two clamps are connected
- Over-charge protection**
Effectively prevent over-charge of the battery in the jump starter
- Over-discharge protection**
Effectively prevent over-discharge of the battery in the jump starter
- Over-current protection**
Protect when discharge current too high
- Over-temperature Protection**
Automatically stop working when the temperature is getting too high
- Reverse Polarity Protection**
No damage happened while the clamps are connected in wrong terminals
- Reverse-charge Protection**
No reverse charging back to Carku unit after the vehicle started
- Over-voltage protection**
Prevent there is big voltage difference between each cell

Product Name	Lithium Battery
Model No.	DSL B01
Battery Capacity	12000mAh(44.4Wh)
Output	5V=1A,5V=2.1A,12V=10A
Input	QC2.0(5V2.4A,9V-2A,12V-1.5A)
Full charging time	4-5 hours
Start Current	200A
Peak Current	400A
Size	128*97*50.5mm
Weight	560g
Operating Temperature	-20°C ~ 60°C

Tg50

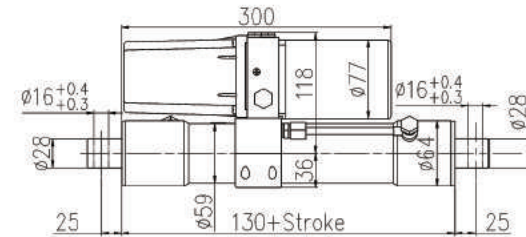

Electro-hydraulic putter		
Model No.:	Tg50	Tg50+
Voltage	12V/24V/48V	48V
Power	300W	800W
Stroke	100-400mm	100-400mm
Jacking Force	2.5T	2.5T
Pull Back	1.5T	1.5T
Lifting Speed	5~6mm/s	10~12mm/s
Working Temperature	-20~60°C	-20~60°C
Use Frequency	For long-term and continue use, 4 minutes each time	For long-term and continue use, 6 minutes each time
Waterproofing Grade	IPX6.5	IPX6.5



Tg32

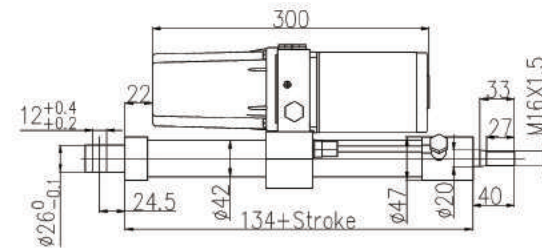

Electro-hydraulic putter		
Model No.	Tg32	Tg32+
Voltage	12V/24V/48V	48V
Power	300W	800W
Stroke	100-800mm	100-800mm
Jacking force	1T	1T
Pull Back	0.5T	0.5T
Lifting speed	10~12mm/s	20~25mm/s
Working Temperature	-20~60°C	-20~60°C
Use Frequency	For long-term and continue use, 4 minutes each time	For long-term and continue use, 6 minutes each time
Waterproofing Grade	IPX6.5	IPX6.5



HS04/10

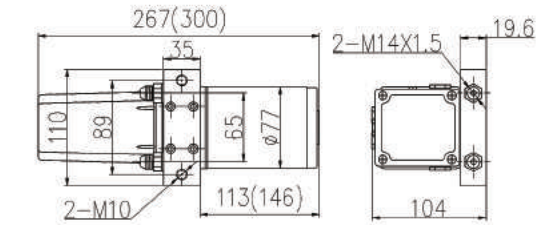

Electric hydraulic station		
Model No.	HS04-350	HS10-350
Voltage	12V/24V/48V	48V
Power	300W	800W
Tank Volume	350ml	350ml
Max.pressure	15MPa	15Mpa
Flow Rate	9ml/s	19ml/s
Pump Type	Bidirectional gear pump	Bidirectional gear pump
Hydraulic Fluid	L-HV 46#	L-HV 46#
Working Temperature	-20~60°C	-20~60°C
Use Frequency	For long-term and continue use, 4 minutes each time	For long-term and continue use, 6 minutes each time
Waterproofing Grade	IPX6.5	IPX6.5

LD45-150

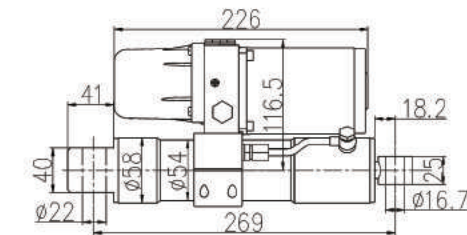

Outboard hydraulic lifting device	
Model No.	LD45-150
Voltage	12V
Power	300W
Stroke	150 mm
Jacking Force	2.0T
Collision Protection	Yes
Lifting Speed	6~8.5mm/s
Working temperature	-20~60°C
Noise	Less than 80 dB
Waterproofing Grade	IPX7

M6/M7

High Pressure Washer

FEATURES:

- 1. More popular with new shape design;
- 2. Convenient handle easy to carry;
- 3. Powerful, high efficiency and longer lifetime;
- 4. Matched with water pressure gauge and faster cooling motor;
- 5. Multifunctional high pressure washing machine, not only for cleaning cars, but for watering the lawn, cleaning walls, windows and so on;



Technical Parameters	M6	M7
Voltage	220V/50Hz	220V/50Hz
Power	≤1.5KW	1.5KW
Pressure	6-9MPa	6-9MPa
Flowing	8.0L/min	8.0L/min
Package	Color Box	Color Box
Weight	10.3/11.1kgs	12.2/13.1kgs
Master carton size	417*213*298mm	412*305*298mm
set/ctn	1pc	1pc
20FT	1060pcs	750pcs